



Daily Layout for Children (Version: 25th August 2021)

This plan will remain under constant review and may be amended where school management see a need.

Arrival/Drop-off

The school is being organised into two **Groups, A and B.**

Group A should arrive at school between 8.45 and 8.55 (By 8.55 at the latest)
 Group B should arrive at school between 8.55 and 9.05 (By 9.05 at the latest)
 Every effort was made to accommodate larger families, but this is not always possible.
 Children should only arrive within the times given to ensure large numbers of people are not arriving together. **We are asking that 1 parent do the drop-off.**

1. Children should wash hands at home before coming to school.
2. Children should enter through the designated doors only (Please see the map)
3. Each child should sanitise hands inside the door
4. The children should make their way to their classroom **without delay.**
5. We have a 'Walk on the left' policy in the school.
6. When your child arrives at the classroom, they should sit in their own seat and place their coat in their bag/on the back of their chair.

Group A	Group B	Entrance:
Junior infants – Ms. Mahon (6)	Junior infants – Mr. Mount (5)	A
Senior infants – Ms. Swan (4)	Senior infants – Ms. Mehta (3)	B
1 st Class – Ms. Bates (1)	1 st Class – Ms. Deay(2)	B
2 nd Class – Mr. O Reilly (17)	2 nd Class – Ms. O Neill/Ms. Farren	E (PE hall)
3 rd Class – Ms. Ryan (15)	3 rd Class – Ms. Harney (16)	E (PE hall) Exit main door
4 th Class – Ms. O Donovan (13)	4 th Class – Mr. Dunne (14)	F
5 th Class – Ms. Whelan (11)	5 th Class – Ms. Smyth (12)	F/G
6 th Class – Ms. Crosbie (10)	6 th Class – Ms. O Riordan (9)	G
ASD Classes		ASD entrance

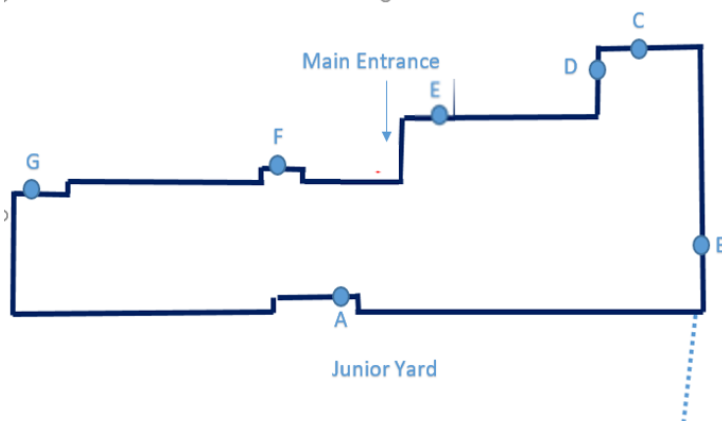

- Adults should not enter the building with the children. If you are having difficulties, please come to the main office to speak with a member of staff. **Please note, just one adult is permitted in the main reception area at any time to ensure proper social distancing.**
- Toilets are not available to parents or children at drop-off times.

During Class time	<ol style="list-style-type: none"> 1. Desks will be laid out to maximise space between groups (junior classes) and between individual pupils in the senior classes. 2. Children in classrooms will be seated in smaller groups called 'Pods'. This will limit larger contact. The hope is that we could rearrange pods on occasion. 3. Interactions between class groups can happen via camera in the classes and in other creative ways. We will continue to use digital learning in a creative way. 4. The children will have their own sets of materials to hand to limit sharing items where possible. The pods will allow a certain amount of sharing. 5. Children will be encouraged to wash/sanitise hands during the day.
Break Times	<p>Break times will differ for each group mentioned above:</p> <p><u>Break</u> Group A: 10.20 – 10.30 Group B: 10.45 – 10.55</p> <p><u>Lunch</u> Group A: 12.00 – 12.25 Group B: 12.50 – 1.15</p> <p>Teachers working in a particular group will supervise this group only. The yards will be separated by tape to keep individual classes separate. Children will be encouraged to play within pods where possible.</p>
Collection Time	<p>The two groups will finish at different times and will be collected at these different times: Group A: 2.35 (1.35 for infant classes)* Group B: 2.45 (1.45 for infant classes)*</p> <p>ASD classes will leave by bus/ASD exit door.</p> <p>Junior infants – 2nd class children will be collected from the doors through which they entered in the morning. Parents should form a queue while observing social distancing outside the door. As always, we encourage families to walk/cycle to school to avoid traffic congestion.</p> <p>3rd – 6th class children will be released through the doors through which they entered that morning (With the exception of 3rd class who will be released through the main doors) Parents from 3rd – 6th class are encouraged to give their child permission to walk by themselves. If you do need to collect your child, please queue outside the designated door while observing social distancing of 2 metres.</p> <p>We ask that all families make their way from the campus as quickly as they can.</p>